



Kimley-Horn  
and Associates, Inc.

BULLETS 060, 4801 CHARLOTTE PARK DRIVE  
CHARLOTTE, NORTH CAROLINA 28217  
PHONE 704-383-9101 FAX 704-383-0848  
Revisions:



**MORGANTON / LENOIR AIRPORT  
OPTION II SITE DEVELOPMENT**  
BURKE COUNTY / CALDWELL COUNTY, NORTH CAROLINA



Scale: 1" = 400'  
Job No.: 05400002  
Drawn By: ACP  
Checked By: RAC  
Date: 7/8/02  
Sheet: SITE DEVELOPMENT  
4 of 4

This document, together with the concepts and designs presented herein, is an instrument of service, is intended only for the specific purpose and client for which it was prepared. Review of and proper reliance on this document without written authorization and approval by Kimley-Horn and Associates, Inc. shall be without liability to Kimley-Horn and Associates, Inc.  
Copyright Kimley-Horn and Associates, Inc. 2000

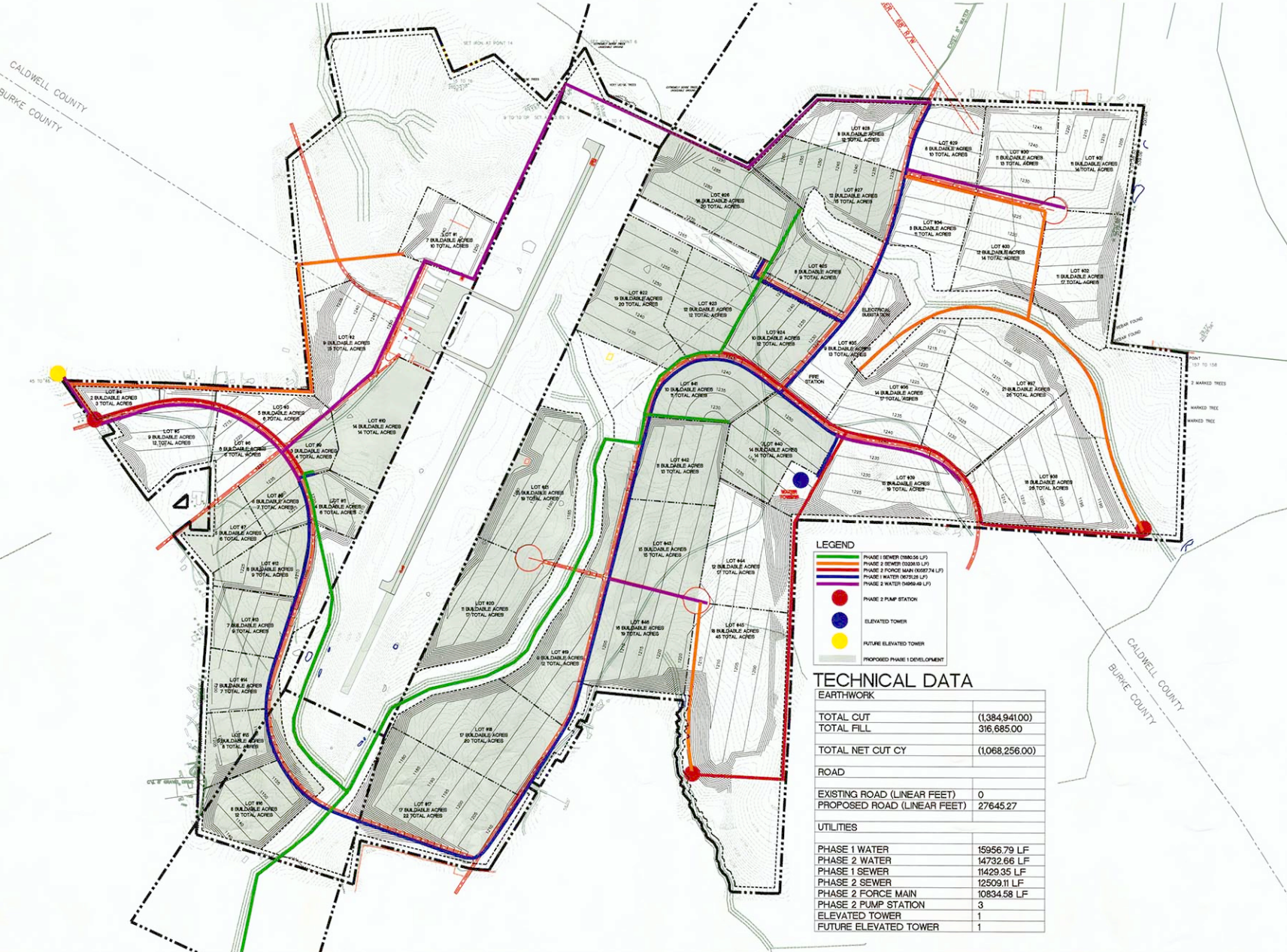
topog



**LEGEND**

- PHASE 1 SEWER (0800-50 LPI)
- PHASE 2 SEWER (0308-10 LPI)
- PHASE 3 FORCE MAIN (0807-74 LPI)
- PHASE 1 WATER (0675-28 LPI)
- PHASE 2 WATER (0869-49 LPI)
- PHASE 2 PUMP STATION
- ELEVATED TOWER
- FUTURE ELEVATED TOWER
- PROPOSED PHASE I DEVELOPMENT

**TECHNICAL DATA**

<b>EARTHWORK</b>	
TOTAL CUT	(1,384,941.00)
TOTAL FILL	316,685.00
TOTAL NET CUT CY	(1,068,256.00)
<b>ROAD</b>	
EXISTING ROAD (LINEAR FEET)	0
PROPOSED ROAD (LINEAR FEET)	27645.27
<b>UTILITIES</b>	
PHASE 1 WATER	15956.79 LF
PHASE 2 WATER	14732.66 LF
PHASE 1 SEWER	11429.35 LF
PHASE 2 SEWER	12509.11 LF
PHASE 3 FORCE MAIN	10534.58 LF
PHASE 2 PUMP STATION	3
ELEVATED TOWER	1
FUTURE ELEVATED TOWER	1